

Medium Throw Over Loops

Used to secure joining points of gates together.

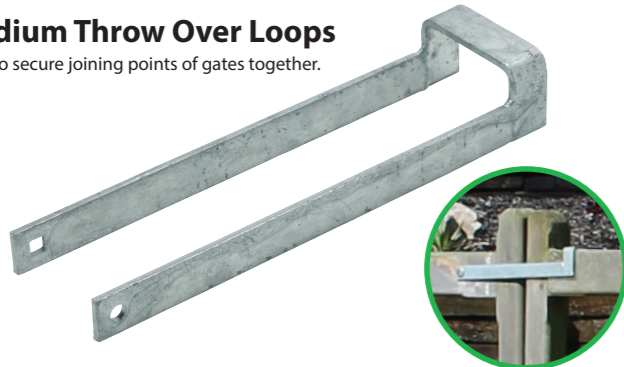

No.156/M

Standard 13" Fieldgate Hooks to Bolt -19mm Pin

Heavy Duty. Ideal for Timber or Concrete posts.

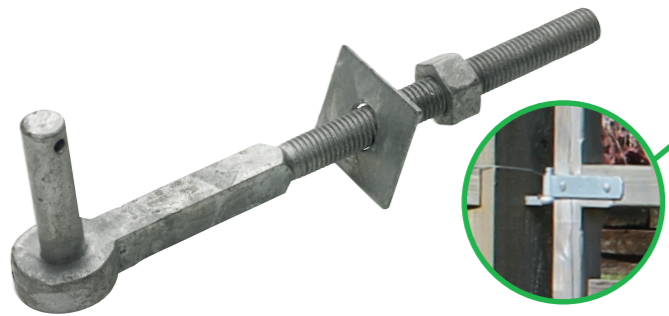

No.131B

Adjustable Bottom Gate Fittings

Used at the base of gate hinge side for placing and positioning hanging gates.

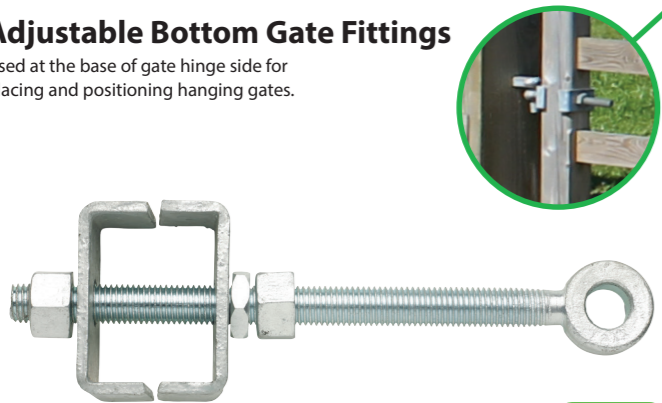

No.167AB

Hooks to Build

Designed to use in brick piers and cementing into masonry.



No.144B



Hooks on 4" x 4" Plates with Extended Shoulder

Heavy Duty Hook on Plate to suit Field Gate double Bands. Enables gate to be lifted on or off for maintenance purposes.

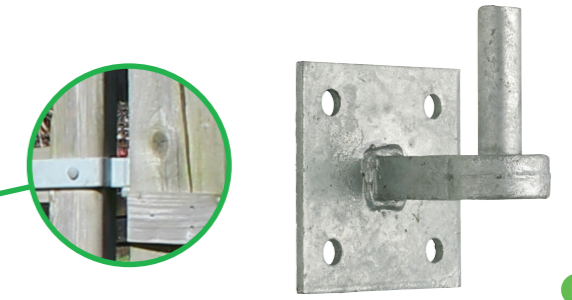

No.153EX

Traditional Cast Cabin Hooks

For use on external and internal doors, sheds and gates.



No.37

Traditional Garage Door Drop Bolts

Used to secure joining points of gates together.

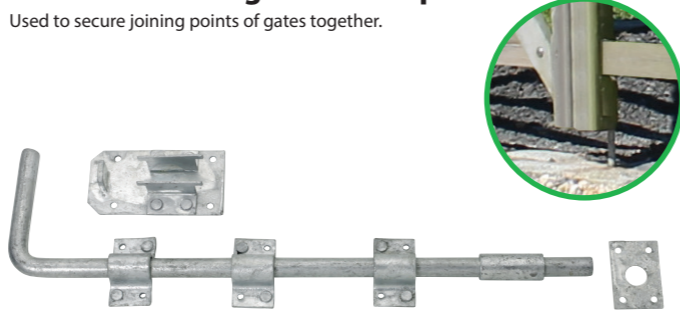

No.260/TRAD

Heavy Fieldgate Hinge Sets

Suitable for 75mm (3") Timber Gates.

- Supplied with fixings

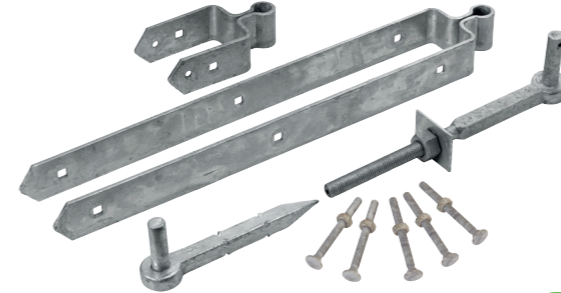

No.131H

Adjustable Bottom Fieldgate Hinge Sets

Suitable for 75mm (3") Timber Gates. Enables easy adjustment of the gate once in situ.

- Supplied with fixings

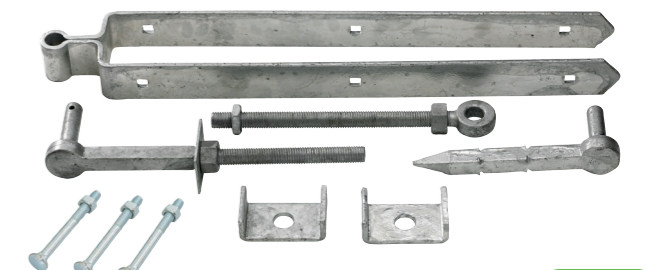

No.167/PP

Fieldgate Lock through Hook to Bolt

Designed to stop hook twist and movement.



No.137

Heavy Fieldgate Sets with 4" x 4" Plates

Suitable for 75mm (3") Timber Gates. The 4" x 4" hooks on the square plates can be fixed to either timber, masonry or concrete posts.

- Supplied with fixings



No.131/153

Adjustable Bottom Fieldgate Hinge Sets with 4" x 4" Plates

Suitable for 75mm (3") Timber Gates. Ideal for DIY.

- Supplied with fixings

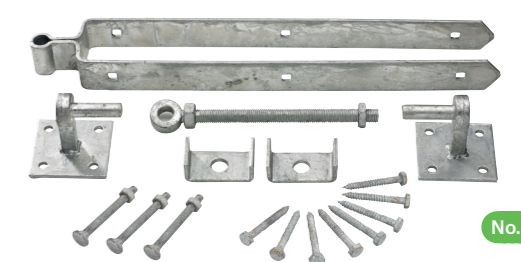

No.167/153